

SONAMP® DIGITAL AMPLIFIERS

2-100 & 12-50 MULTI-CHANNEL POWER AMPLIFIERS



Product Overview

Sonance, the inventor of the distributed audio amplifier category, introduces the next generation of cutting edge amplifier technology. Once again pushing the envelope with class-leading performance, rock-solid stability, and ease of installation, the Sonamp Digital Amplifier line appeals to the

most discerning ear. With enough flexibility to meet the demands of custom installations of all types & the perfect compliment to the rest of the Sonance speaker line. The Sonamp Digital Amplifiers build on the legacy of innovation, performance and reliability that Sonance amplifiers are known for.

Features and Benefits

- Powerful, audiophile grade Class-D power supply. Rated at 8 ohms, 4 ohms & stable into 2 ohms.
- Compact form factor allows for space savings in the equipment rack with ample power to the speakers.
- Convection cooled, fanless design allows for direct stacking with no air gap for even greater power density.
- Bridgeable channels for applications when even more power is required.
- Class-D design is 93% efficient for maximum power output with minimal power usage.
- Full array of input/output connectivity for maximum installation flexibility: line inputs, loop outputs, audio & voltage triggers, (2) Buss input/output, independent volume control per channel.
- Terminal blocks will accept up to 12AWG speaker cable for longer runs & higher performance.
- Certified to worldwide safety standards (TUV, RCM, CE). Meets FCC standards.
- Rack ears and removable feet included.

2-100



12-50



2-100 Dimensions

Dimensions with Feet

Width: 8 5/8" (219mm)
 Height: 2 1/8" (54mm)
 Depth: 16 13/16" (427mm)

Dimensions with Rack Ears & without Feet

Width: 19" (482mm)
 Height: 1 3/4" (44mm)
 Depth: 16 13/16" (427mm)

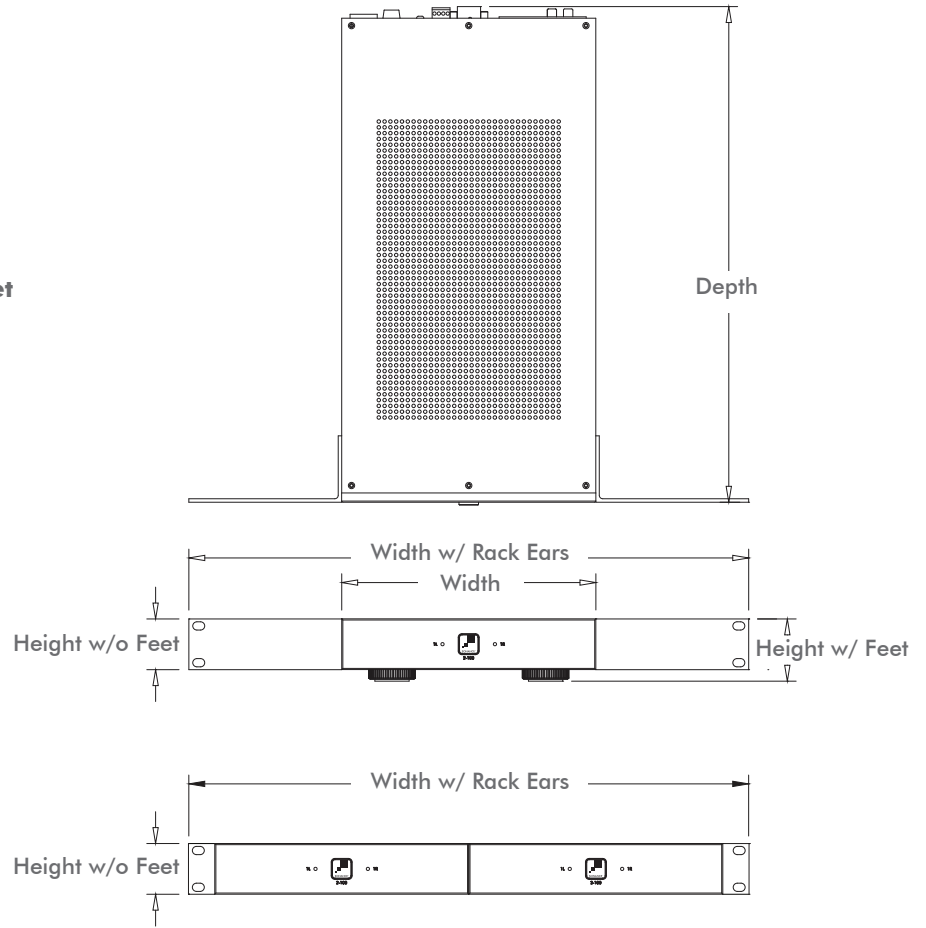

(2) 2-100 Digital Amplifiers shown with optional Rack Mount Bracket

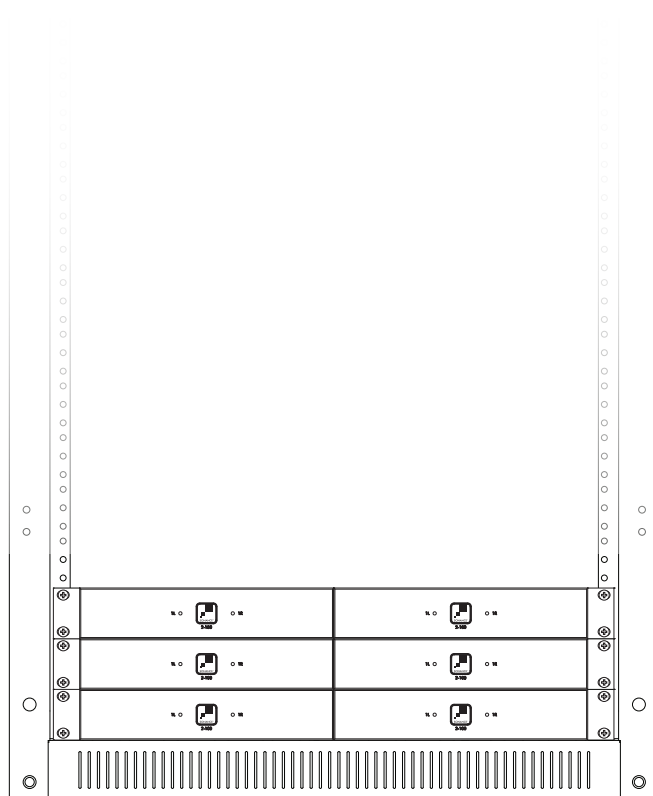

- Compact form factor allows for space savings in the equipment rack with ample power to the speakers
- Convection cooled, fanless design allows for direct stacking with no air gap for even greater power density.
- Class-D design is 93% efficient for maximum power output with minimal power usage.
- Rack ears included. Removable feet.

12-50 Dimensions

Dimensions with Feet

Width: 17 1/4" (438mm)
 Height: 3 7/8" (98mm)
 Depth: 16 13/16" (427mm)

Dimensions with Rack Ears & without Feet

Width: 19" (482mm)
 Height: 3 1/2" (88mm)
 Depth: 16 13/16" (427mm)

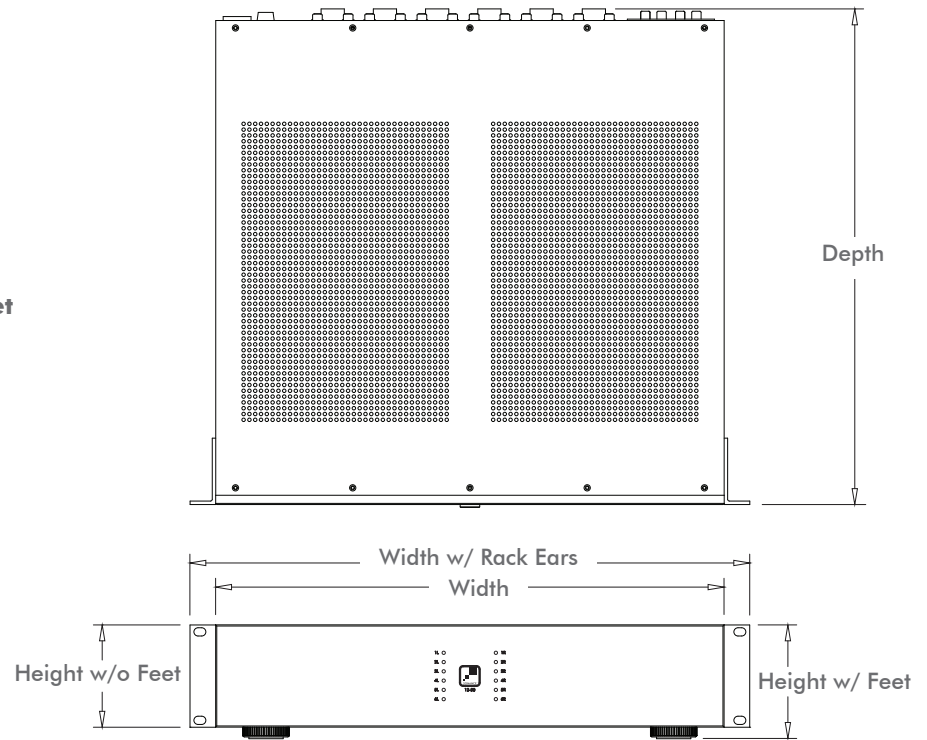

- Compact form factor allows for space savings in the equipment rack with ample power to the speakers
- Convection cooled, fanless design allows for direct stacking with no air gap for even greater power density.
- Class-D design is 93% efficient for maximum power output with minimal power usage.
- Rack ears included. Removable feet.

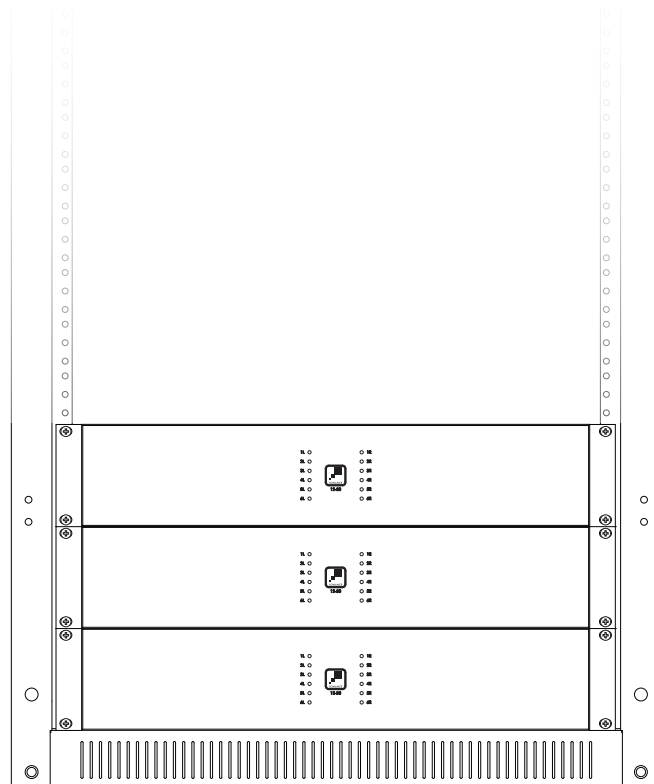



SPECIFICATIONS 2-100

SKU	93091
UOM	Each
Number of Channels	2 (1 stereo pair)
Power Output (RMS):	
RMS per channel @ 8 ohms	100 Watts (2 channels driven)
RMS per channel @ 4 ohms	156 Watts (2 channels driven)
RMS per channel Bridged @ 8 ohms	325 Watts
Frequency Response	5Hz – 50kHz, bandwidth limited
Total Harmonic Distortion (THD):	
(1kHz) @ 8 ohms	0.15%
(1kHz) @ 4 ohms	0.1%
AC Voltage	100-120V@60Hz, 220-240V@50Hz
AC Fuse	5A (T5AL ~ 250V)
Dimensions w/ Feet (W x H x D)	8 5/8" x 2 1/8" x 16 13/16" (219mm x 54mm x 427mm)
Dimensions w/ Rack Ears w/o Feet (W x H x D)	19" x 1 3/4" x 16 13/16" (482mm x 44mm x 427mm)
Rack Space Requirement	1U – 1/2 Rack Width
Shipping Weight	10 lbs (4.53kg)



SPECIFICATIONS 12-50

SKU	93092
UOM	Each
Number of Channels	12 (6 stereo pairs)
Power Output (RMS):	
RMS per channel @ 8 ohms	50 Watts (12 channels driven)
RMS per channel @ 4 ohms	50 Watts (12 channels driven)
RMS per channel Bridged @ 8 ohms	100 Watts
Frequency Response	5Hz – 50kHz, bandwidth limited
Total Harmonic Distortion (THD):	
(1kHz) @ 8 ohms	0.05%
(1kHz) @ 4 ohms	0.1%
AC Voltage	100-120V@60Hz, 220-240V@50Hz
AC Fuse	10A (T10AL ~ 250V)
Dimensions w/ Feet (W x H x D)	17 1/4" x 3 7/8" x 16 13/16" (438mm x 98mm x 427mm)
Dimensions w/ Rack Ears w/o Feet (W x H x D)	19" x 3 1/2" x 16 13/16" (482mm x 88mm x 427mm)
Rack Space Requirement	2U
Shipping Weight	20 lbs (9.07kg)



Associated Products

Rack Mount Bracket for Sonamp 2-100 & DSP 2-150

SKU# 93098

Note: Allows two 1/2 rack width amps to be rack mounted together in a 1U rack space.

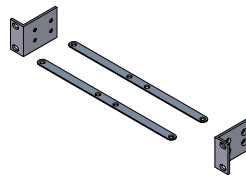

ASAP3D SE (Special Applications Amplifier)



SONAMP DSP AMPLIFIERS

DSP 2-150



DSP 8-130



DSP 2-750



LIMITED TWO (2) YEAR WARRANTY

Sonance warrants to the first end-user purchaser that this Sonance-brand product ("Product"), when purchased from an authorized Sonance Dealer/Distributor, will be free from defective workmanship and materials for two (2) years. Sonance will at its option and expense during the warranty period, either repair the defect or replace the Product with a new or remanufactured Product or a reasonable equivalent.



©2014 Sonance. All rights reserved.

Sonance and Sonamp are registered trademarks of Dana Innovations.

Due to continuous product improvement, all features and specifications are subject to change without notice. For the latest Sonance product specification information visit our website: www.sonance.com

SONANCE • 212 Avenida Fabricante • San Clemente, CA 92672-7531 USA
(949) 492-7777 • FAX: (949) 361-5151 • Technical Support: (949) 492-7777
www.sonance.com