

| REVISIONS | | | | |
|-----------|------|--|----------|----------|
| ECN | REV. | DESCRIPTION | DATE | APPROVED |
| | A | RELEASE FOR PRODUCTION | 05-29-08 | |
| | B | UPDATE DRAWING | 05-05-20 | |
| 21017 | C | UPDATED TO PG11 GLAND UPDATE MATERIAL THICKNESS | 03-31-21 | |

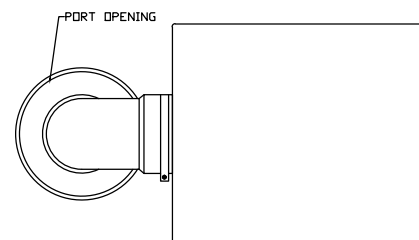

NOTES:

- 1: MATERIAL - 5052 ALUMINUM
UNLESS OTHERWISE SPECIFIED
- 2: FINISH - STUDIO BLACK POWDER COAT
UNLESS OTHERWISE SPECIFIED
- 3: MARINE GRADE
- 4: IMPEDANCE - 4 OHMS

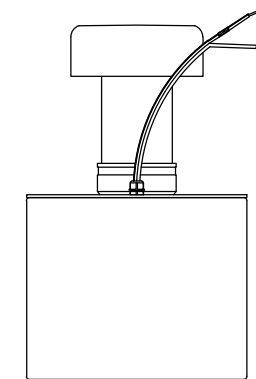
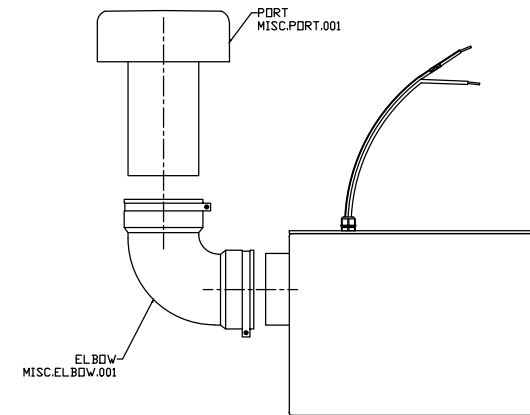
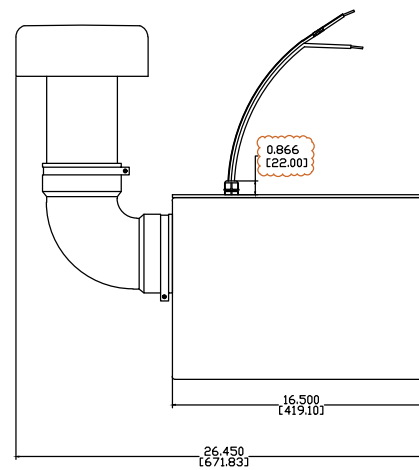
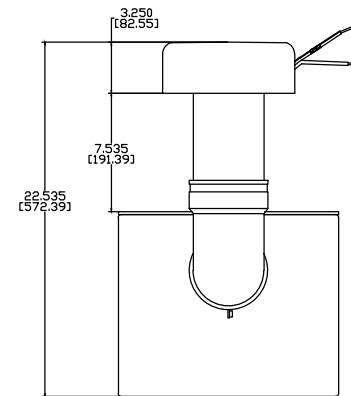
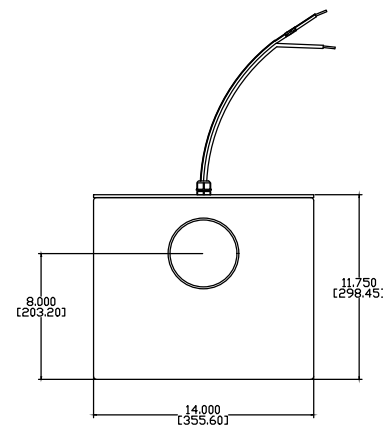
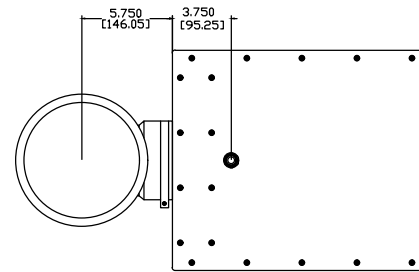
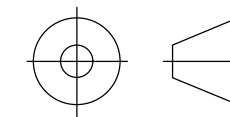

"THIRD ANGLE" PROJECTION

PROPRIETARY INFORMATION
THE DESIGNS, INFORMATION, AND DATA CONTAINED HEREIN ARE PROPRIETARY AND ARE SUBMITTED IN CONFIDENCE, AND SHALL NOT BE DISCLOSED, USED OR DUPLICATED IN WHOLE OR IN PART, FOR ANY PURPOSES WHATSOEVER, WITHOUT THE PRIOR WRITTEN PERMISSION OF JAMES LOUDSPEAKER LLC, 2185 PARK PL, MINDEN, NV 89423. THIS LEGEND SHALL BE MARKED ON ANY REPRODUCTIONS HEREOF IN WHOLE OR IN PART. RECEIPT OF THIS DOCUMENT SHALL BE DEEMED TO BE AN ACCEPTANCE OF THE CONDITIONS SPECIFIED HEREIN.

JAMES LOUDSPEAKER

ST12

EXTERNAL DIMENSIONS

P/N: -

DWR #: 080529-A00

REVISED BY: M. GARCIA

DRAWN BY: M. PARK

DATE: 05-29-08

APPROVED:

DRAFTING APPROVED:

SCALE:

TOLERANCES: ANG: ± = .5° FRACT. ± = 1/32
DECIMALS: .XX ± = .01 .XXX ± = .005

REVISION: A

SHEET 1 OF 4