

REVISIONS				
ECN	REV.	DESCRIPTION	DATE	APPROVED
	A	RELEASE FOR PRODUCTION	11-09-21	

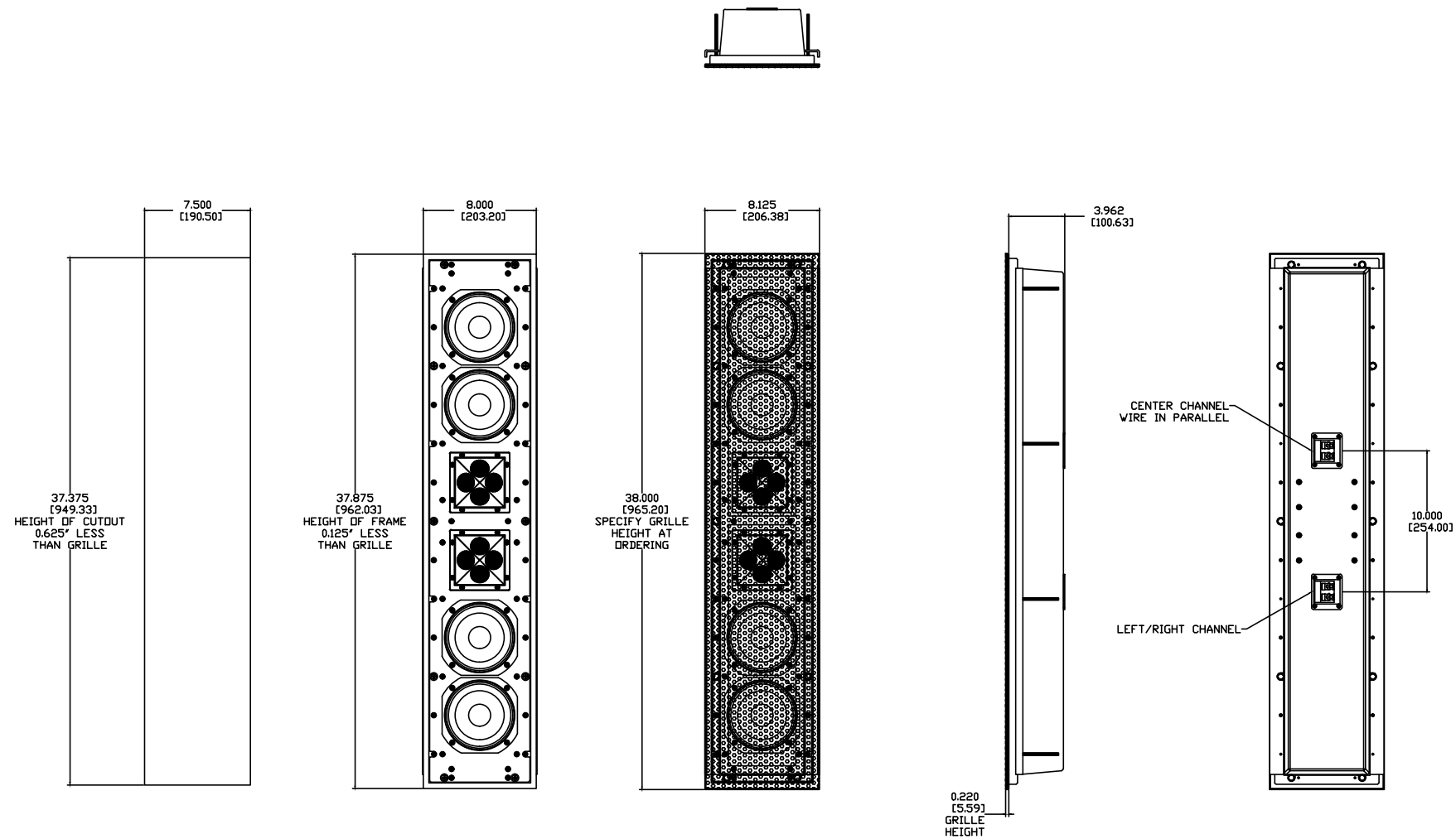

NOTES:

- 1: MATERIAL - 5052 ALUMINUM  
UNLESS OTHERWISE SPECIFIED
- 2: MINIMUM GRILLE HEIGHT - 25"
- 3: CONFIGURATION FOR 75" TV SHOWN; DRIVER CONFIGURATION VARIES WITH LENGTH
- 3: FINISH:  
GRILLE - GLOSS WHITE POWDER COAT  
FRONT PLATE, MOUNTING PLATE, GRILLE FRAME - STUDIO BLACK POWDER COAT  
HOUSING, BRACKET - TBD  
UNLESS OTHERWISE SPECIFIED

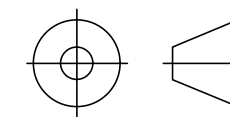

"THIRD ANGLE" PROJECTION

PROPRIETARY INFORMATION  
THE DESIGNS, INFORMATION, AND DATA CONTAINED HEREIN ARE PROPRIETARY AND ARE SUBMITTED IN CONFIDENCE, AND SHALL NOT BE DISCLOSED, USED OR DUPLICATED IN WHOLE OR IN PART, FOR ANY PURPOSES WHATSOEVER, WITHOUT THE PRIOR WRITTEN PERMISSION OF JAMES LOUDSPEAKER LLC, 2185 PARK PL, MINDEN, NV 89423. THIS LEGEND SHALL BE MARKED ON ANY REPRODUCTIONS HEREOF IN WHOLE OR IN PART. RECEIPT OF THIS DOCUMENT SHALL BE DEEMED TO BE AN ACCEPTANCE OF THE CONDITIONS SPECIFIED HEREIN.

JAMES LOUDSPEAKER

QX-SPL5-CS

EXTERNAL DIMENSIONS

P/N: QX-SPL5-CS

DWR #: 211109-S101

REVISED BY:

DRAWN BY: S. LDESCH

DATE: 11-09-21

APPROVED:

DRAFTING APPROVED:

SCALE:

TOLERANCES: ANG: ± = .5° FRACT. ± = 1/32  
DECIMALS: .XX ± = .01 .XXX ± = .005

REVISION: A